

# Arnolds | Keys



## The Old Pig Barn, Helsdon Farm Norwich Road, Hanworth, £2,250 Per Calendar Month

- Substantial and Versatile Detached Barn Conversion
- Rural Location off A140 and Convenient For Aylsham and North Norfolk Coast
- Large South Facing Rear Garden and Ample Parking
- Conservatory and Ample Parking
- 4 Reception Rooms
- Large Fitted Kitchen / Breakfast Room
- Adjoining and Overlooking Fields and Woodland
- 5 Bedrooms
- En Suite, Shower Room and Bathroom
- Oil Central Heating and Double Glazing

25 King Street, Norwich, Norfolk, NR1 1PD  
01603 216812

lettings@arnoldskeys.com  
www.arnoldskeys.com

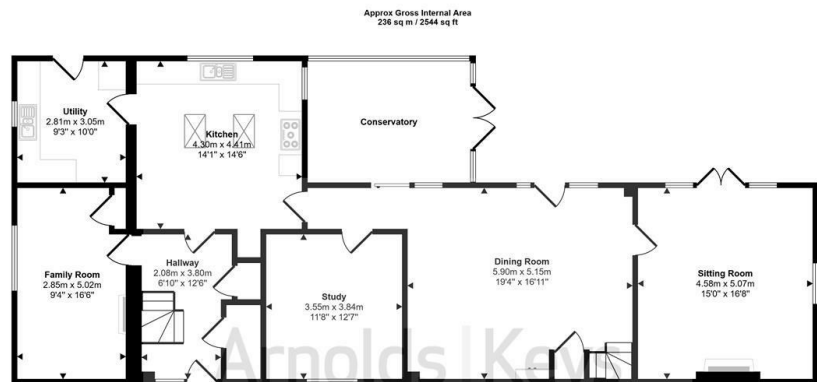

Ground Floor  
Approx 143 sq m / 1544 sq ft

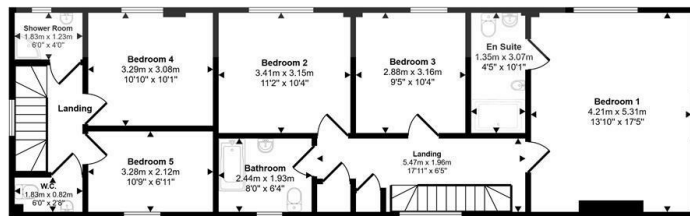

First Floor  
Approx 92 sq m / 1000 sq ft

This floorplan is only for illustrative purposes and is not to scale. Measurements of rooms, doors, windows, and any items are approximate and no responsibility is taken for any error, omission or misstatement. Items of items such as bathroom suites are representations only and may not look like the real items. Made with Made Snappy 360.

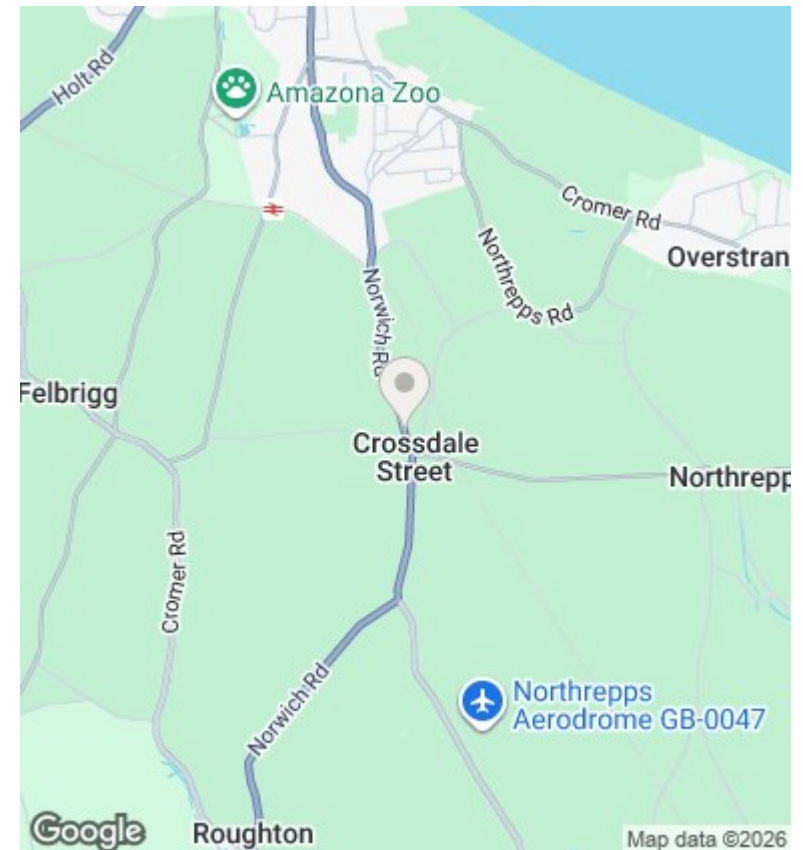

## Directions

## Viewings

Viewings by arrangement only. Call 01603 216812 to make an appointment.

## Council Tax Band

E

## EPC Rating:

C

Energy Efficiency Rating		Current	Potential
Very energy efficient - lower running costs			
(92 plus)	A		
(81-91)	B		
(69-80)	C		
(55-68)	D	69	77
(39-54)	E		
(21-38)	F		
(1-20)	G		
Not energy efficient - higher running costs			
England & Wales		EU Directive 2002/91/EC	

25 King Street, Norwich, Norfolk, NR1 1PD  
01603 216812

lettings@arnoldskeys.com  
www.arnoldskeys.com